



Instructions

Sportster Derby Cover Kit

NOTE

On models with mid-controls, it will be necessary to remove the left footrest support for removal and replacement of the derby cover. Use supplied spacer when replacing footrest support to allow for sufficient clearance. Refer to Figure 1 below.

BQUAZY Sportster recommends installation be done by qualified individuals.

Models

These Kits are designed to fit 1994 to 2003 XL Sportster model motorcycles.

Kit Contents

- 1 - Derby Cover
- 4 - Stainless Steel Socket Head Cap Screws
- 1 - Spacer for left footrest support
(when using mid-controls)

Mid-Controls

1. If you have mid-controls you will need to first remove the left footrest support in order to install your new Derby Cover. Remove the two bolts (Figure 1 item 6) on the support.
2. Use the supplied spacer when replacing your footrest support using your stock bolts. Tighten the screws to 45-50 **ft-lb** (62-68 Nm) We recommend using Blue Loctite® on the screws to prevent loosening.

Figure 1.

FOOTREST ASSEMBLY (1991-2003 MODELS)

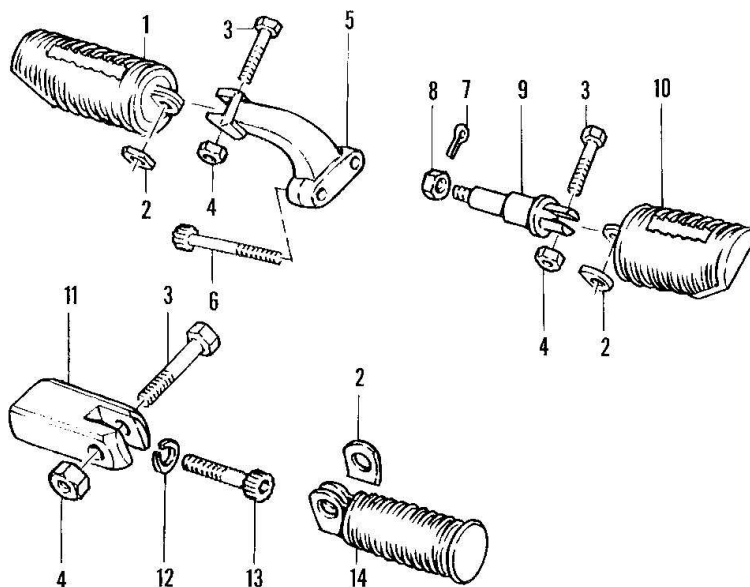

1. Footpeg
2. Spring washer
3. Bolt
4. Locknut
5. Support
6. Bolt
7. Cotter pin
8. Locknut
9. Footrest clevis
(all models except 883C, 1200C and 1200S models)
10. Footpeg
11. Footrest clevis
(883C, 1200C and 1200S)
12. Lockwasher
13. Bolt
14. Footpeg

Installing Derby Cover

1. Remove the existing screws and washers that secure the clutch spring (derby) cover. Remove the original cover. See Figure 2 items 1 & 2.
2. Inspect o-ring (Quad ring, see Figure 2 item 11) for damage. If this shows wear, cracks or damage replace with Harley-Davidson part number 25463-94.
3. Wipe o-ring surface clean of any excess oil or debris for proper seal.
4. Install the new cover and socket head cap screws. We recommend using Blue Loctite® on the screws to help keep them secure. Tighten screws in a crosswise pattern to 84-108 **in-lbs.** (9.5-12.2 Nm)
5. If you have mid-controls refer to page 1 to replace the footrest support.

Figure 2. Primary Drive Cover (1994-2003 Models)

1. Torx screw and washer
2. Clutch spring cover
3. Spring
4. Lockplate
5. Nut
6. Coupling (1994-1996 models)
7. Outer ramp
8. Balls (3)
9. Coupling (1997-2003 models)
10. Inner ramp
11. Quad ring
12. Snap ring
13. Primary drive cover
14. Clutch adjusting screw assembly
15. Clutch cable
16. O-ring

